

# SCH8916HOARM HOLD-OPEN ARM INSTALLATION DIAGRAM

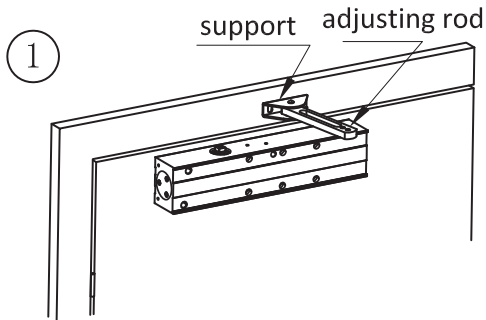

1- Fix the main body onto the door according to the installation dimensions in the manual.  
2- Loosen the toothed screw on the folding arm, remove the part connected to the adjusting rod and the support. Fix the support onto the door frame according to the installation dimensions in the manual.

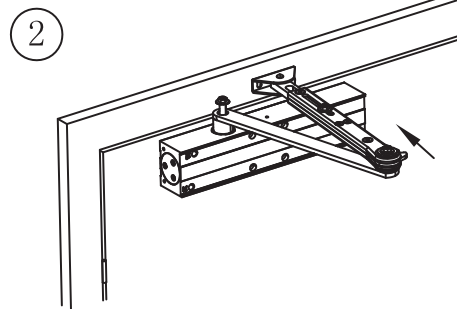

1-Insert the adjusting rod into the folding arm.  
2-Adjust the angle of the rocker arm rod, connect the corners of the rocker arm head with the main body's tooth shaft, and tighten the screw.

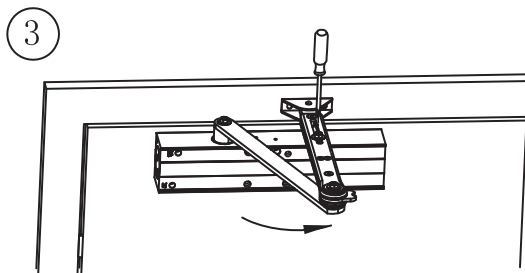

1-Rotate the rocker arm rod in the direction of the arrow to adjust the folding arm to a vertical position with the door frame.  
2-Use a Phillips screwdriver to tighten the toothed screw on the folding arm.

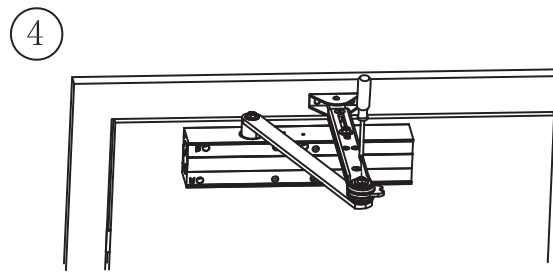

Open the door to the desired stop angle, ensuring that the teeth on the adjustment plate engage correctly with the teeth on the main arm bracket (to prevent slipping), and then tighten the toothed screw with an internal Phillips screwdriver.

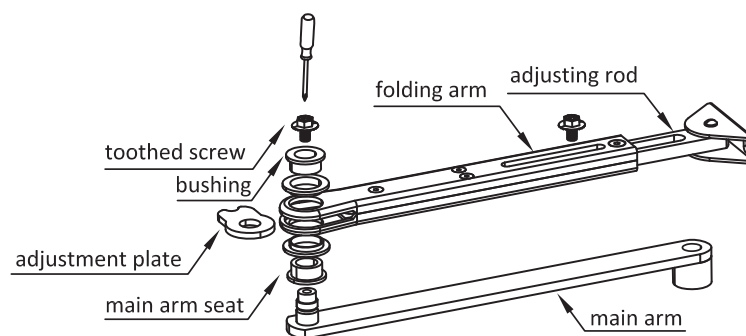

The positioning angle is factory-set between 90° and 100°. If you need to set the positioning angle, first loosen the toothed screw, then fix the door at the desired stop angle, and finally tighten the toothed screw.

**Note:**  
Stop to open the door once it reaches the desired angle, do not push the door hard, otherwise may damage the door or hinge.