

SCH8416HDCUARM HEAVY-DUTY CUSH ARM

ADJUSTABLE POWER DOOR CLOSER

INSTALLATION INSTRUCTION SHEET

PUSH SIDE MOUNTED (PARALLEL ARM) D.S.

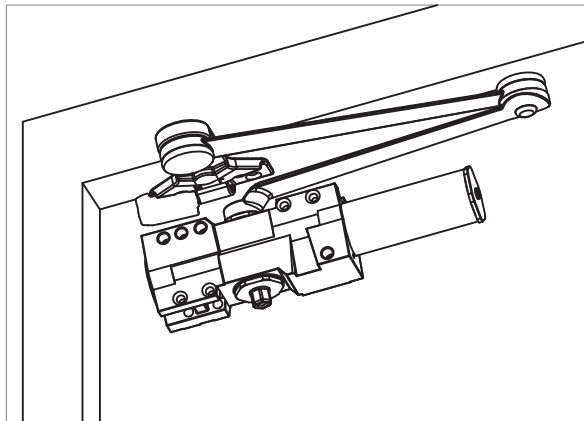

Standard Installation

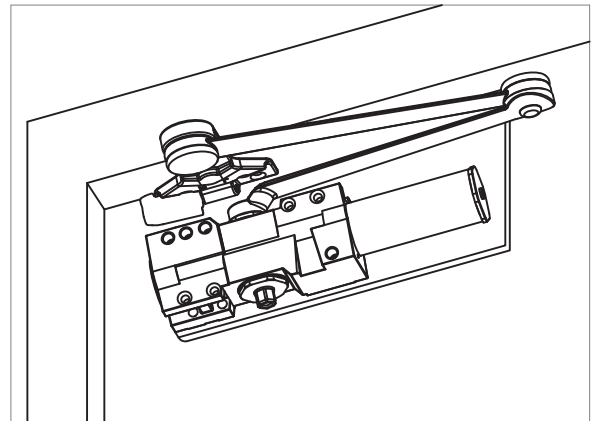

Install on Drop Plate

GENERAL NOTES

The closer is non-handed and designed to meet entrance accessibility requirements. Before installation, determine hand of door first. Refer to the drawing (right), then the proper installation template.

The closer can be adjusted to handle all exterior doors up to 4'0" and interior doors up to 5'0" wide. Before installing the closer, adjust the spring power as shown below (right). Turn the spring adjustment nut clock-wise (C.W) or counter-clockwise (C.C.W) the required number of turns to match door width as indicated in chart below (left).

MAXIMUM DOOR WIDTH		FULL TURNS REQUIRED
EXTERIOR DOORS	INTERIOR DOORS	
	5lb-f*	5 TURNS C.C.W
	8.5lb-f*	34" 2 TURNS C.C.W
30"	38"	0 TURNS
36"	48"	5 TURNS C.W
42"	54"	10 TURNS C.W
48"	60"	15 TURNS C.W

* Opening Force on 36" Door

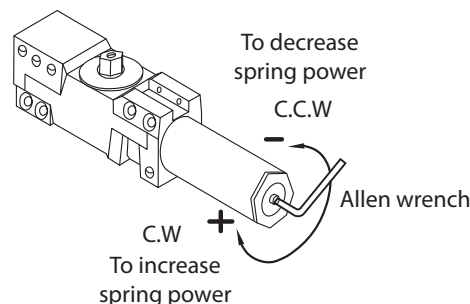

HOW TO TELL HAND OF DOOR

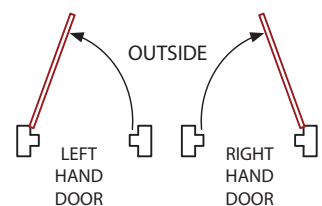

CLOSER CONTROL DIAGRAM

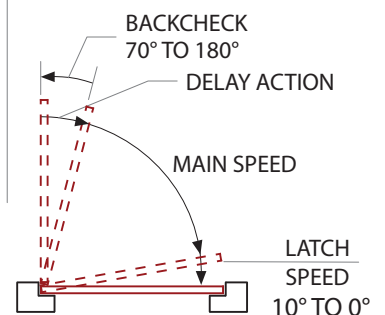

IMPORANT: When adjusting spring power, DO NOT exceed the maximum number of turns in either direction! Beyond either masimum number of turns may damage closer.

MOUNTED STOP FACE (PUSH SIDE) PARALLEL ARM

TOP RALL LESS THAN 5 1/2" DROP PLATE WILL BE REQUIRED
(AVAILABLE FROM DEALER) MAXIMUM OPENING 110°

PUSH SIDE MOUNTING

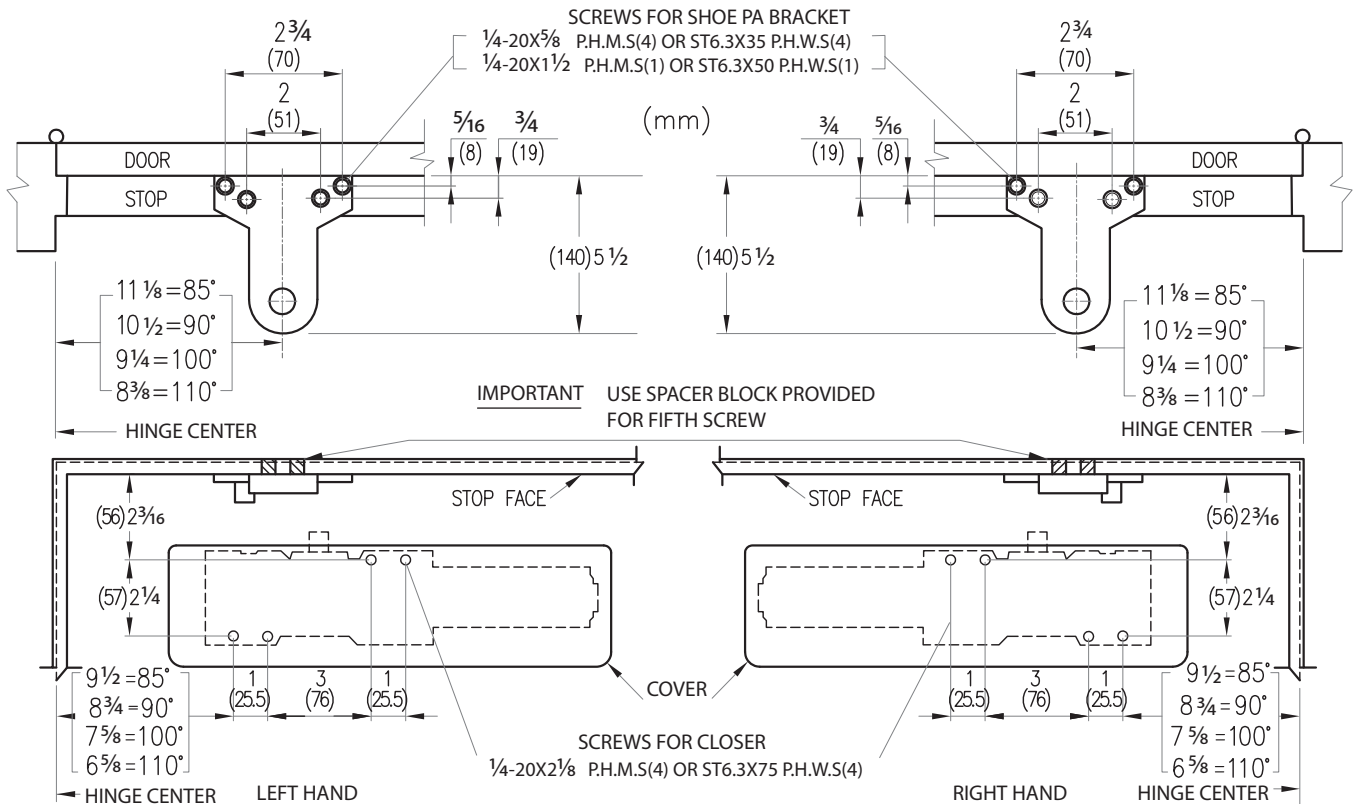

Before installing the mounted stop face (parallel arm), turn the backcheck selector valve (located on the side opposite the regulating screw) all the way in (clockwise).

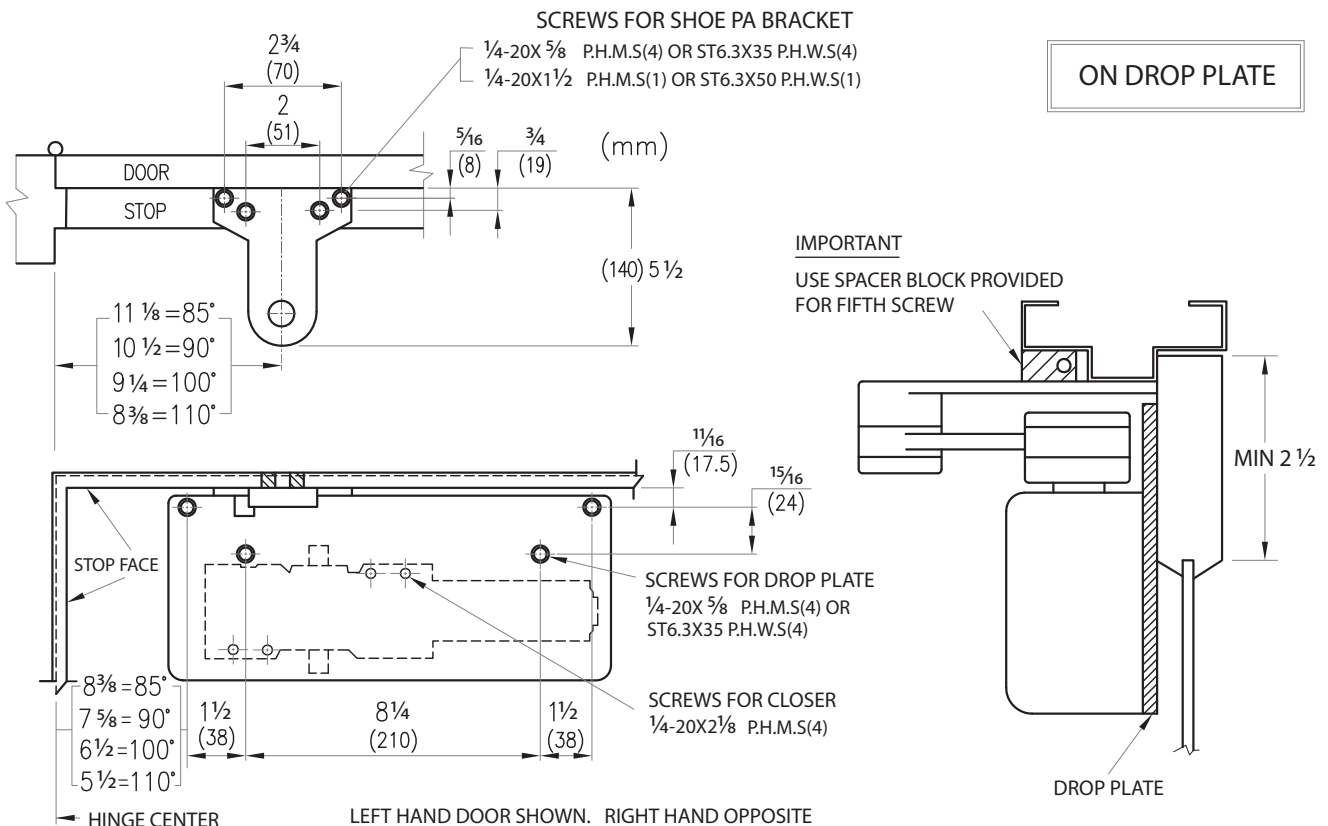

CAUTION

IMPROPER INSTALLATION OR REGULATION
MAY RESULT IN PERSONAL INJURY
OR PROPERTY DAMAGE
FOLLOW ALL INSTRUCTIONS CAREFULLY.
FOR QUESTIONS, CONTACT DEALER

Fig.1

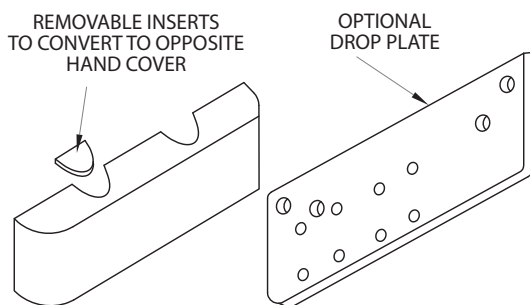
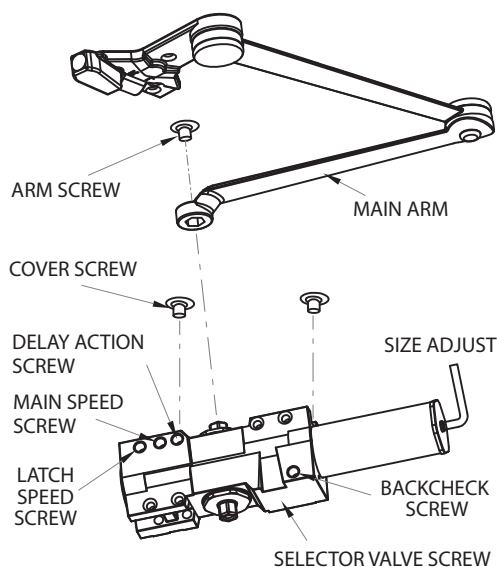
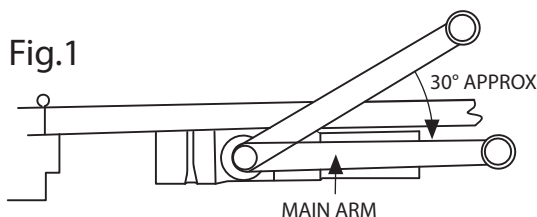

INSTALLATION & ADJUSTMENT INSTRUCTIONS

BEFORE INSTALLING THE ARM -TURN BACKCHECK SELECTOR VALVE (on back of closer) ALL THE WAY IN.

1. Adjust spring power to match door width as indicated by chart on front page.
2. Select proper templating on opposite page, based on degree of opening/dead stop. The closer and arm holes must be located for same degree of opening /dead stop. Drill and/or tap mounting holes in door & head jamb.
3. Attach complete arm to closer, as shown at left. Arm will be at about a 30° angle to closer body. Fasten with arm shaft screw. The arm will appear to be in an incorrect position. This is to accommodate the pre-load required for parallel arm mounted door closers.
4. Mount closer on door, using fasteners provided.
NOTE: Arm will provide some resistance.
5. Swing door open about 45°. Mount shoe to frame stop per proper templating on opposite page. Be sure to install the "fifth" screw. If stop is not wide enough, use spacer block provided.

REGULATION

CAUTION DO NOT BACK VALVES OUT OF CLOSER OR A LEAK WILL RESULT

The closer has been regulated prior to shipment. If adjustments are necessary, carefully follow instructions.

CLOSING SPEED: See Closer Control Diagram on page 1.

To adjust Main Speed, turn regulating (reg.) screw clockwise to decrease or counter-clockwise to increase.

To adjust Latch Speed, turn reg. screw clockwise to decrease or counter-clockwise to increase. Reg. screw locations are shown to the left and on labels.

BACKCHECK: is essential for proper operation of Cush-Stop. Use enough backcheck to prevent arm from striking the arm stop with force.

To increase resistance, turn reg. screw clockwise.

DO NOT USE ABRUPT BACKCHECK!

6. Attach cover: place cover insert into proper slots for either R.H.or L.H.door. Place cover over closer and hold against door while tightening cover screws firmly.

Spring CUSH (SCUSH)

Spring CUSH arms (SCUSH) have specific instructions for mounting the SCUSH shoe. Otherwise, SCUSH arms install like a regular CUSH arm.



IMPORTANT!



DO NOT reduce the closer's backcheck setting! Spring CUSH arm function does not replace backcheck.

1 Locating

- In new installations, use the standard CUSH template.
- When replacing an existing CUSH arm, use the existing mounting holes.

2 Installation

- Mount the shoe onto the frame.
- Use a 5/32" or 4mm hex wrench to install the contact block assembly, as shown below.
Make sure the screw is tightened securely into the shoe.

3 Completing installation

- Left Hand (LH) shown. Right Hand (RH) opposite.

